

Earth revolution

The direction of the earth's revolution is from west to east. One complete revolution takes one year.

Because the earth's axis is tilted during revolution the sun's intensity varies throughout the year, resulting in changes in the four seasons.

The model shows the four seasons of the northern hemisphere.

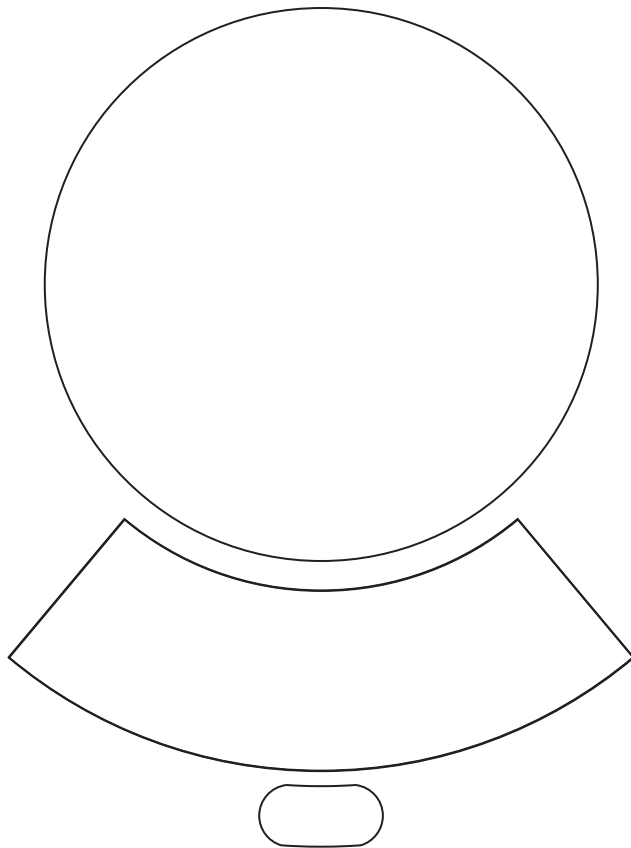

Limitation of the model

This model focuses on the relationship between the position of the earth's revolution and the seasons. The actual orbit of the earth's revolution is similar to an ellipse, and the distance from the sun also changes.

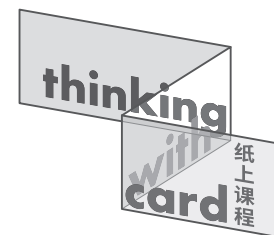

thinkingwithcard.com

Part 1

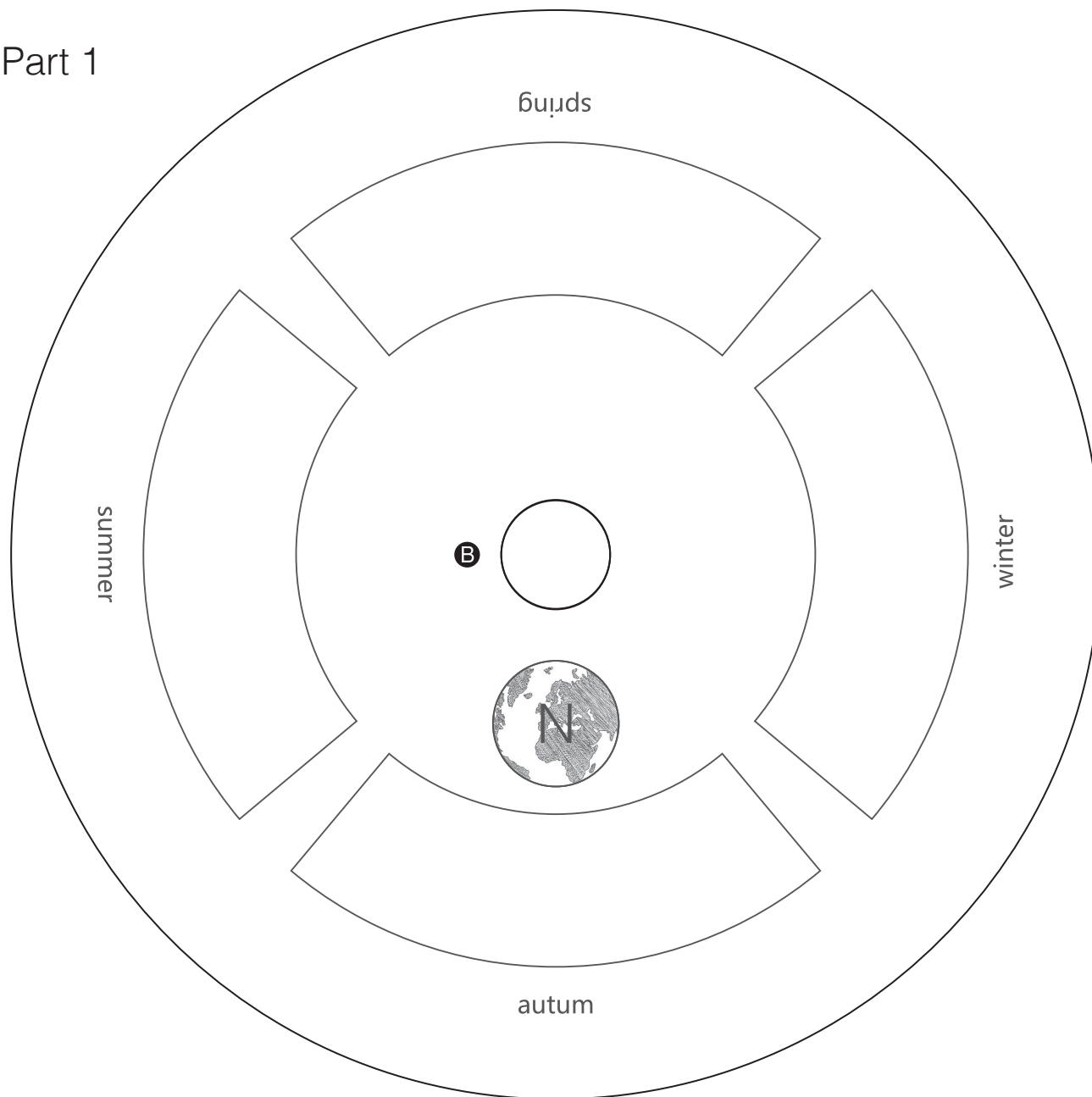

Part 2

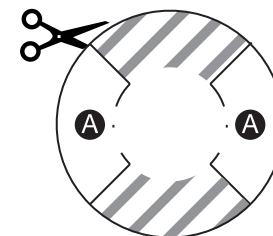

Part 3

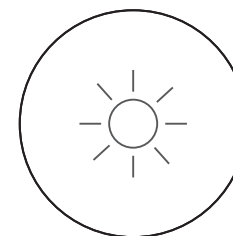

-  glue zone
-  valley fold line
-  mountain fold line
-  cut line

①

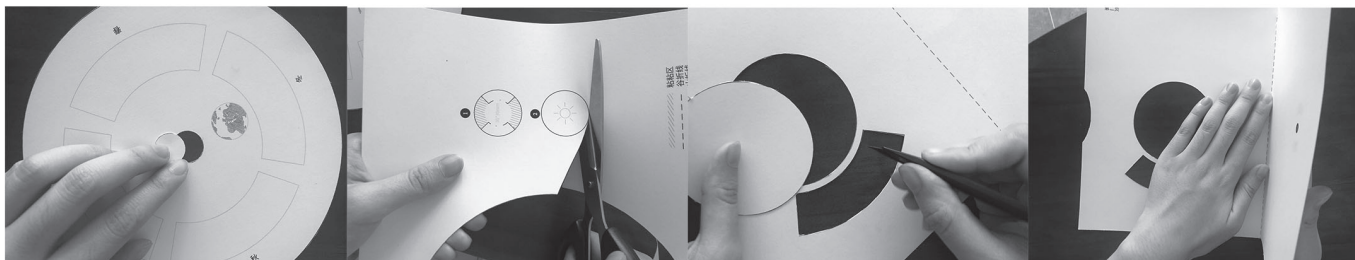

②

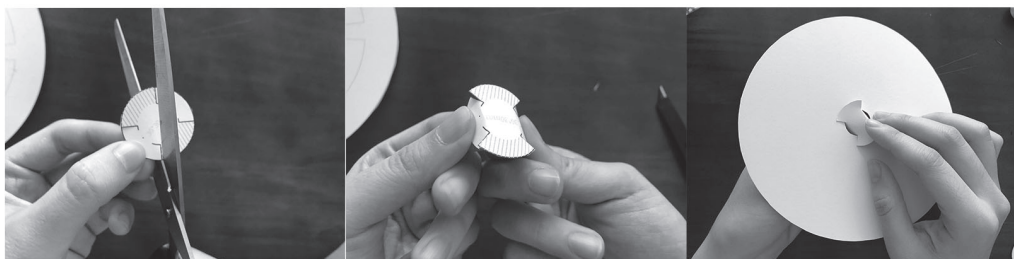

③

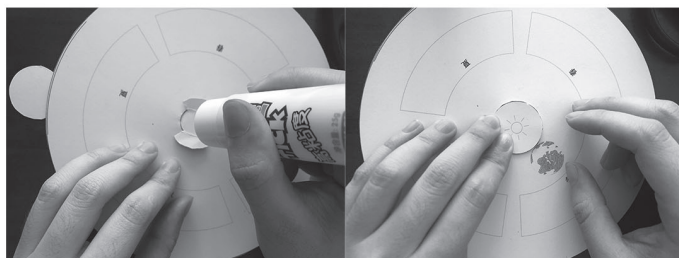

④

⑤

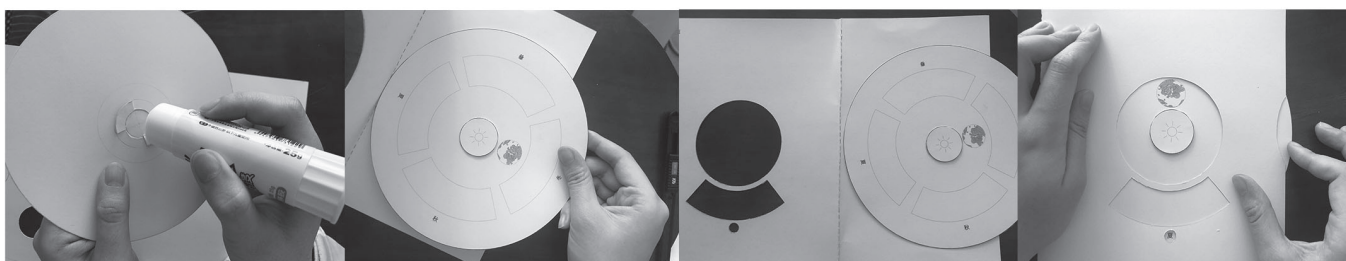

- ① Cut out all parts as shown and fold the main card along the valley fold line
- ② Cut part 2 along the cut line, fold and insert **A** through hole **B** on part 1
- ③ Glue part 3 on to part 2 using the glue zone marked.
- ④ Glue the back of **A** to the glue zone also marked **A** on the main card.
- ⑤ You can create illustrations for each of the seasons and add your own information.

Design: 杨惠茹 and Ben Hughes.

This work is licensed under a Creative Commons
Attribution-NonCommercial-NoDerivatives 4.0
International License

本作品采用知识共享署名 4.0 国际许可协议进行许可

